



TOWNE TWIN
— VILLAGE —

Celebration

**INAUGURAL
ANNUAL REPORT**

APRIL 2024



Dear Friends of Towne Twin Village,

What for many years seemed impossible to accomplish because of the lack of acceptance, the lack of funding or fill in the blank with the list of reasons that creating a single site permanent supportive housing community could not be possible, we have proved it possible and made it a reality for the many unsheltered individuals with no other housing options. It is a time of celebration and thanks as we could not and cannot be successful without an army of support from donors, volunteers and an incredible board and staff.

Permanent Supportive Housing or PSH is not a new term that just appeared in the recent past; in fact, I heard the term almost ten years ago while helping to build a Coordinated Homeless Response System and leading the effort to end Veteran Homelessness while working for the City of San Antonio. It has taken several years to educate our community on how important this type of housing is and how beneficial it is, especially in assisting chronically unhoused individuals remain stably housed for several years while reducing costs and strain on hospital systems, first responders and our local judicial system.

I was able to participate and lead several other initiatives while working for the city, such as the creation of the comprehensive senior center, where members sustain vibrant, active, and engaged communities through socialization and activity. I have carried that work to the culture we are building here at Towne Twin Village because I know from experience that being part of a community improves the quality of life for all residents, volunteers and staff.

I am thankful for my experiences with the city and especially thankful for the many partners who have made this vision come to fruition. As we transition people from the harsh conditions of living unhoused to new homes with access to medical, dental and behavioral health supports, I see our residents overcome the trauma they have experienced throughout their lives. The partnerships we have established over the last few years are vital to the success of our campus. The volunteers who have given their time and energy since April of 2023 are often the lifeline for some of our residents. I also want to thank my staff; they are so compassionate, so professional and I am proud to be leading such a great team.

Towne Twin Village is leading a new response to homelessness. We could not do it without you. Thanks for all you do for our residents. Your continued support will be necessary as we prepare to open the Medical Building and double our population on campus.

Sincerely,

Edward Gonzales

Edward Gonzales





Housing First Community Coalition Mission Statement

To initiate and sustain a Permanent Supportive Housing community (Towne Twin Village) using Housing First principles for the most marginalized and vulnerable individuals in the San Antonio region.

Board Members

Mark Wittig, Board Chair, 2017 - Present

Chris Plauche, Board VP, 2017 - Present

Paul Vance, Board Secretary/Treasurer, 2017 - Present

Steve Markey, Board Member, 2017 - Present

Alice Salinas, Board Member, 2021 - Present

Robert Guevara, Board Member, 2021 - Present

Beverly Watts Davis, Board Member, 2017 - Present

Linda Mascorro, Board Member, 2020 - Present

Ezra Johnson, Board Member 2023 - Present





Staff Members

Edward Gonzales, Executive Director

Laura Nickel, Support Services Program Director

Valarie Oldhorn, Lead Care Coordinator

Felicia Scruggs, Care Coordinator

Johnny Gaona, Care Coordinator

Fredy Paco, Care Coordinator

Raquel Martinez Flores, Care Coordinator

Beth Pocta, Volunteer Coordinator

Kallie Harper, Lead Housing Coordinator

Dionisia Peveler, Case Aide

Daniela Avila Sarquis, Case Aide

James Wilson, Housing Coordinator

Bee Rosa Sanchez, Lead Case Aide

Patricia Jones, Case Aide

Fernando Velazquez, Facilities and Maintenance Manager

Remijio “Ram” Garcia, Groundskeeper/Maintenance

Damien Lopez, Groundskeeper/Maintenance

Esther Rendon, Administrative Assistant



Towne Twin Village

4711 Dietrich Rd. San Antonio, TX 78219

<https://housingfirstsa.org/towne-twin-village/>



Towne Twin Village Celebrates One Year of Operations



Our Work and Who We Serve

HFCC developed Towne Twin Village to serve chronically homeless, vulnerable individuals (ages 55 and older) through Permanent Supportive Housing using evidenced-based Housing First principles to create a trauma-informed culture. We believe that all residents, volunteers, and partners are vital to creating a supportive, collaborative environment that is welcoming and life-giving.

Commissioner Tommy Calvert has been an advocate for HFCC since its inception. The Commissioner stated, “The Housing First Community Coalition with the support of the Catholic Worker House has charged us to get in line with the best practice of putting housing first and wrap-around services in one place.”



“Our homeless population is expected to increase by an additional 6,000 people than the thousands we already have. That means we need to be building another thirty Towne Twin Villages to keep our community on the right track by 2030.”

- Tommy Calvert



Our History: Persistence, Passion and Compassion

Housing First Community Coalition (HFCC) was founded in 2017 by several long-standing volunteers and supporters of San Antonio Catholic Worker House (CWH). Through community volunteer work at the Catholic Worker House, the founding HFCC board members realized that although providing daily meals, clothing, hygiene supplies, book, movies, and laundry service greatly assists individuals experiencing homelessness with daily basic needs, CWH members continued to experience homelessness year after year. As a result, the Board members shared a vision to develop a compassionate Permanent Supportive Housing site with wrap-around services where the most vulnerable can live and heal in a very respectful, individualized way.

After years of searching for a property, HFCC purchased and rezoned 17.3 vacant acres on Dietrich Road located on San Antonio's east side and designed and built San Antonio's first Permanent Supportive Housing Campus – Towne Twin Village (TTV). The land was once the location of the Towne Twin Village Drive-In Theater, which opened in 1956 and closed in 1983.

TTV hired Edward Gonzales to serve as Executive Director in October of 2021. When he was hired construction had not yet started. Using his years of experience in working with housing for the City of San Antonio, Edward was able to work strategically with numerous partners to make it possible for 65 residents to call TTV home in 2023. By the end of this year there will be a total of 120 residents on campus. Upon completion of the project, over 200 formerly unhoused individuals will have permanent homes.

Neighborhood buy-in and engagement is key to sustaining a truly vibrant and compassionate community. The City of San Antonio shared this with the Board when the property on Dietrich was purchased. Since then, Mayor Ron Nirenberg and the City, Bexar County and numerous other supporters have been proud members of our ever-growing coalition of the willing.



“Towne Twin Village embodies the spirit of empathy, compassion, and community that makes San Antonio such a beautiful place. All people are deserving of safe, dignified housing, and Towne Twin plays such a critical role in providing that housing to those who need it most. There’s often a stigma to facilities that serve our unhoused population, but this space has proven to be an asset our residents can be proud of.”

- District 2 Councilman Jalen McKee-Rodriguez

When a Dream Comes to Fruition

It all started with a dream. Actually, that is not true. It started when Chris Plauche, MD made a bargain with God on May 13, 2005. That's when it actually started. Finding herself totally burnt-out with being an expert in autism and with pressing deadlines to complete a textbook chapter, Chris prayed for God to show her the way. In return, her part of the bargain was to give 20 hours a week to any ministry, especially one out of her comfort zone. All she needed was an answer.

She went to bed that night and had a very vivid dream. In her dream, Chris was with her pastor in the Alamodome. The arena was empty except for the two of them. The pastor excused himself to go to the restroom. When he didn't return, Chris decided to go check on him. Upon entering the bathroom, she saw her pastor ministering to a man who appeared to be homeless. When she woke up, she simply thought that her dream was odd. A thought went through her head, "Really God? I have never thought about people who are homeless."



That morning, after her dream, she really did have an appointment with her pastor. It was his last day serving at the church and he wanted to give her a gift. She did not look at the gift until she left that meeting and got in her car. The gift was a book on Dorothy Day and the Prayer of Abandonment by Brother Charles de Foucauld. Another sign from God. Dorothy Day was the founder of the Catholic Worker Movement. Another hint regarding homelessness.

Later that same day, Chris took a wrong turn and was on Commerce Street under the bridge for the first time. She remembers the hundreds of unhoused men and women under that bridge very vividly. She remembers a large group of people swarming her car looking for food. And she realized ... God was talking. Chris calls these three signs in less than 24 hours the "sacred synchronicities."



And this was just the beginning. Chris decided to go into the desert for her next step. During her sabbatical, she spent time living like a hermit, totally connecting to God and nature through spiritual readings, prayers, reflection and listening. It was in listening that she heard a powerful message – **Bloom where you are planted.** The significance of this short but powerful message is that Chris was interested in relocating at the time.

In 2005, Chris started serving as the Director (in a volunteer capacity) of San Antonio’s Catholic Worker House, a position Chris continues to hold today.

Chris is a lifelong learner and in 2008 went to Oblate School of Theology to earn her Masters of Spirituality. In one of her classes the professor, Sister Maria Cimperman, RSCJ assigned a project. Chris named her project **Pee Free with Dignity.** At that time, San Antonio started issuing citations for public urination and yet locked all of the public bathrooms. She met with Sister Maria several times regarding her project and kept getting the same feedback, “Think bigger, Chris. Why do these people need a bathroom?”. The immediate thought Chris remembers is, “Duh! They don’t have houses.”

Chris thought bigger. Fifteen years later, her dream has come to fruition. She created and designed almost everything on TTV’s campus. Paying attention to the smallest detail allowed her to bring San Antonio exactly what was needed – a place individuals who are 55 and older can call home.

HFCC Board Chair Mark Wittig states, “Love your neighbor as yourself. What if your neighbor is hungry? Lonely? Scared? Broke? Abused? You are blessed if you know someone who takes this seriously. We who know Chris Plauche are blessed. It was from her passion to serve the homeless, her doggedness to care for those who have so little and her determination to see this dream realized that a true collaborative was birthed.”



Residents of TTV and unhoused guests across the city gather in the Day House for breakfast and lunch. The beautiful building allows guests and visitors to escape the heat and be a part of a compassionate community.



Towne Twin Village Transformed My Life

Dates are so vivid for some individuals. This is especially true for Towne Twin Village (TTV) resident Tonya Jones, who moved on campus on July 20, 2023.

When she arrived at her new tiny home she was finishing chemotherapy for rectal cancer.

On September 19, 2023 Tonya underwent a lengthy surgery to remove the mass and came out with an ileostomy. Tonya was able to spend time healing from the procedure in her new home and five months later on March 20, she had the ileostomy reversed. For the first time since moving to Dietrich Road, Tonya was able to shower.

Tonya is no stranger to adversity. She credits her mother, her son, her uncle Baldy and entire family for supporting her through her very productive and illustrious life. Tonya is a natural leader. Many of her peers on campus do not know her stellar athletic accomplishments in high school and college. As a freshman in high school, Tonya landed a spot on the Sam Houston Varsity Basketball team and a spot on the San Antonio's girl's all-star team, a spot that she kept all four years of high school.

On December 8, 1999, Tonya gave birth to her son, DeShaun Edwards Jones. Being a single parent did not stop Tonya from providing everything she could for her son. DeShaun is Tonya's pride and joy. Being a lot like his mother, DeShaun also excelled in athletics as a kid and earned a track scholarship to Baylor University where he was named the two-time Big 12 Champion in indoor/outdoor hurdles.



On April 6, 2024, Tonya and her Uncle Baldy surprised her son on Senior Day at Ole Miss University.



Many parents are proud of their kid’s accomplishments, but Tonya is extra proud of her son because of the obstacles he had to overcome. On December 6, 2021, Tonya’s mother died leaving her without a support system. She was evicted several months later and found her way to Haven for Hope on November 8, 2022. Tonya spent the next eight months participating in the Integrated Treatment Program. She commenced from the program and stayed, hoping and praying for the possibility of getting a house at TTV.

One would think that this is the ending of the story but for Tonya and her son, the book has a lot more chapters. Tonya, with the help of her Uncle Baldy, surprised her son DeShaun on April 6 of this year for his senior day at Ole Miss University. DeShaun transferred there from Baylor. Surprised does not even explain the reaction DeShaun had when seeing his mother. Tonya stated, “When he opened the door, he hugged me so tight and cried for at least ten minutes. I am so proud of all he has accomplished and look forward to sharing his future successes with him.”

Living at TTV has improved Tonya’s quality of life. She shared, “TTV gave me a roof over my head and various other forms of support services. The staff and volunteers are outstanding! Valarie was my first care manager. She went above and beyond to clean me, help me, listen to me and care for me. She was not afraid to get her hands dirty and even visited me in the hospital. She spoiled me. I am so thankful!”



Nurturing Creativity in an “At-Home” Studio

After living in Rhode Island for over 40 years, Ann relocated to San Antonio. Her professional experience includes owning and operating a costume design company for 35 years. Ann’s favorite memory during her career was creating and designing period costumes. She continues sharing her passion for design and hopes to teach her peers on campus how to sew clothes.

Ann is a lifelong learner, definitely a creator. Since moving into her own home, Ann started dabbling with other forms of art. Ann states, “The quiet and peacefulness of the campus make my home a beautiful place to live and give me an opportunity to develop and hone in on my artistic skills.”

When asked about her painting pictured below, Ann shares, “I am really fond of Lewis Carroll, especially **Alice in Wonderland**. My painting shows an array of characters that I find fascinating.”



“A true artist is not one who is inspired, but one who inspires others.” - **Salvador Dali**



Celebrating Our Community: Partnerships and Initiatives Overview of Services: Day House and Medical Clinic

Community heals. The 65 residents on the Towne Twin Village campus are healing through community care, partnerships and supports – both formal and informal. Research has shown that community is where the most potential exists for healing, especially a community with supportive services on-site that offers individual solutions and interventions.



Day House of Hospitality Serves First Meal

On Monday, May 20, the Day House of Hospitality served its first meal in the new building. With a large commercial kitchen and three dining areas, the building also features a laundromat, showers, barber shop, nailcare salon, hygiene and clothing supply area, mail room, counseling room, and office. Residents and unhoused guests across the city (55 years and older), neighbors and community members are welcome to use the services offered here.

“We have all known the long loneliness and we have learned that the only solution is love and that love comes with community.” - **Dorothy Day**

Clinic Provides Residents with Easy Access to Multiple Services

Research shows that the success of a Permanent Supportive Housing Program relies heavily on intensive and high-quality support services, and that a person's overall health improves significantly with a combination of housing and services. These services go beyond just providing a roof over someone's head; they address the complex needs of individuals experiencing chronic homelessness.



The medical building includes two hospice/respice apartments which can be seen on the left of the building.

The Medical Building will feature the following:

- Medical Clinic with private exam rooms, nurses' station, reception area, charting and case reviewing conference room and an ADA bathroom.
- Dental Clinic with private exam room equipped with dental chair and equipment.
- Mental Health Clinic with four counseling offices.
- Case Management program with offices.
- Large conference room.
- Two Hospice/Respice apartments for the unhoused.

By combining housing with comprehensive services, these programs offer a pathway to stability, improved health, and a better quality of life for some of the most vulnerable members of our communities.



Resource and Administrative Building Illustrates Collaborative Community

Residents have access to the services provided in the Admin Building. This building includes a maintenance work area, administrative offices and a Resident Resource Center. The Resource Center will feature a library with computer stations and popular periodicals and books.



“Towne Twin Village is a beautiful place. I like living here. Everybody uplifts each other. There are no firsts or lasts. I am proud to be a part of the coalition. I see representatives from many of the partner organizations I have had direct contact with in the past on campus and I truly believe that together we are better.”

- Kevin



**HFCC is proud to partner with
the following organizations:**

Alamo Colleges Eastside Education and Training Center
Amigo Animal Hospital
Bexar County
Catholic Worker House
The Center for Health Care Services
City of San Antonio
Close to Home
FORM Communities
Foxhole Ministries
Gardopia
IKEA
Meals on Wheels
Real Estate Council of San Antonio
San Antonio Christian Dental
SAMMinistries
Street Dog Coalition
Street Medicine
Tobit Ministry
Traveling Loaves and Fishes
University Health
University Of Texas Health Science Center at San Antonio – PT and OT Departments
West East Design Firm



Celebrating Volunteers at HFCC

“Never doubt that a small group of thoughtful committed individuals can change the world. In fact, it’s the only thing that ever has.” – Margaret Mead

The goal of the volunteer arm of Housing First Community Coalition’s (HFCC) Towne Twin Village (TTV) is to provide an intersection where individuals, organizations, and residents, meet and in the process, community is built. We are building a culture that we hope volunteers and residents of TTV find mutually beneficial. It is a journey to settle into a new home, neighborhood, and community. Volunteers are an integral part of that journey and are celebrated at TTV.

The response of volunteers who have heard about TTV through social media, the news, touring the campus, or by word of mouth, has been incredible. We have an abundance of individuals and groups who are willing to engage and partner. Since becoming operational, we already have a diverse and rich base of volunteers that is growing quickly. The community would not be able to accomplish all it is doing without the support of volunteers who give their time, talent, and treasure.

It is remarkable how many shapes and forms volunteering can take. From large groups that came in and helped to clear the land so the village could be built, to the individual volunteer who sits and has a conversation with someone they have just met; both the grand and the seemingly mundane are needed and welcome.

From the familiar Aesop’s Fable, The Lion and the Mouse comes the quote, “No act of kindness, however small, is ever wasted.” Conversation, sharing a meal, laughing while watching a movie together, engaging in a shared spiritual experience, helping someone shop or care for their home, adding beauty to the community through maintaining the grounds; all have added value. All of these, in their own way, come together to build community. They break down walls that divide, foster respect for the experiences of others, and emphasize that all are welcome at the community table.



TTV is currently hosting volunteer orientation sessions. The volunteer interest form can be found on the TTV website.

Oak Hills Church Serve Day: Love Out Loud

Thirty members of Oak Hills Church came out to build garden beds on July 1, 2023.



Volunteers Making Memories & Providing Services

The time and space where memories are made bring a lot of beauty into the volunteer experience. It turns a haircut into a conversation, a puzzle or craft into sharing about something that is going on in life, and someone remembering your birthday into something that makes you feel like you are valued. Since July 2023 over 450 volunteers have spent well over 1,000 hours making an impact. Many of the volunteer hours delivering meals, providing social settings to interact, and celebrating holidays, had a direct impact on the quality of life for individuals living at TTV.

In talking to people who call TTV home you hear comments from people who say they are so grateful to live here and that they enjoy it when there are fun things to do. Our residents feel special when their birthdays are remembered, and they enjoy cook-outs where people gather and play music. They like having something to look forward to on weekends.



Fr. Ron Rolheiser, OMI offers a Catholic Mass on Ash Wednesday.

House - to - Home First a House, Then a Home in a Compassionate Community



Volunteer groups make homes ready for 13 individuals on July 15, 2023. A special thank you to all of the individuals who participated in one of our three House to Home projects, a project which included purchasing all of the furniture for each individual home or travel trailer and putting the home together with the furniture, decorations and all household items needed for an individual to feel the presence of home upon first entering his/her front door. A special thank you to our cluster sponsors – Wells Fargo, Frost Bank, the Church of Jesus Christ and the TND Foundation.

Connecting Over Haircuts



Tish Punjabi, who has been coming monthly to provide haircuts, likes to engage with individuals who sit in her chair by asking if they are a native Texan and if not, what brought them to San Antonio. As people begin to share their stories, many of which have heart wrenching components, points of commonality are found. Simple things like being the youngest sibling, having a dog, or where they grew up become points of connection. Tish says that somewhere “through heartache and shared experiences you make a connection, and it just makes you both smile. This smile and connection are what keep me coming back to Towne Twin Village.”

Art Allows Our Residents to Create and Connect

Val Liveoak connected with the community at TTV through a shared partner, Catholic Worker House. She has been one of Catholic Worker House’s faithful food pick up team members. She is also active in helping to run a neighborhood food pantry where she lives. She attended the groundbreaking for TTV and has kept her eye on the progress over the last couple of years. Val has always enjoyed arts and crafts and is incredibly talented across a variety of mediums. She was accustomed to doing her art alone at home, and said, “I wanted to offer to do art and teach in community and I thought this would be a great place to do that.” Val brings not only her artistic talent, but a vision of how items can be repurposed and made beautiful, and a flexibility to meet people where they are. She comes to TTV on a weekly basis helping people create and see beauty.



Val Liveoak, Virginia, and Janie admiring their work of art when ‘puzzling’ broke out at craft time.



“The peacefulness and tranquility of the campus make me very comfortable and happy. There is still hope for people who need it. There are still nice people in the world.”

- **Moises**



Financial Overview – Capital

Phase 1 and Phase 2 campus buildings are in operation or planned to be released for use this fall. Phase 1 consists of 86 residential units (60 tiny houses, 24 travel trailers and 2 apartment units inside the clinic), and 6 community buildings (chapel-multipurpose complex, hospitality pavilion, laundromat, Health Clinic, Hospitality Center and Administration and Resource Center).

Phase 2 consists of 41 residential units (41 tiny Homes), 4 gazebos and 3 community buildings (small community kitchen, second laundry facility and Maintenance Facility). This phase was funded through the City’s affordable housing bond and Bexar County General Fund.

Our final Phase 3 development cost was secured through the City of San Antonio’s bond money. On June 20th the City Council approved \$6.48 million for the construction of the four apartment buildings which will house 80 residents.

DEVELOPMENT COST TOTAL: \$37,855,446

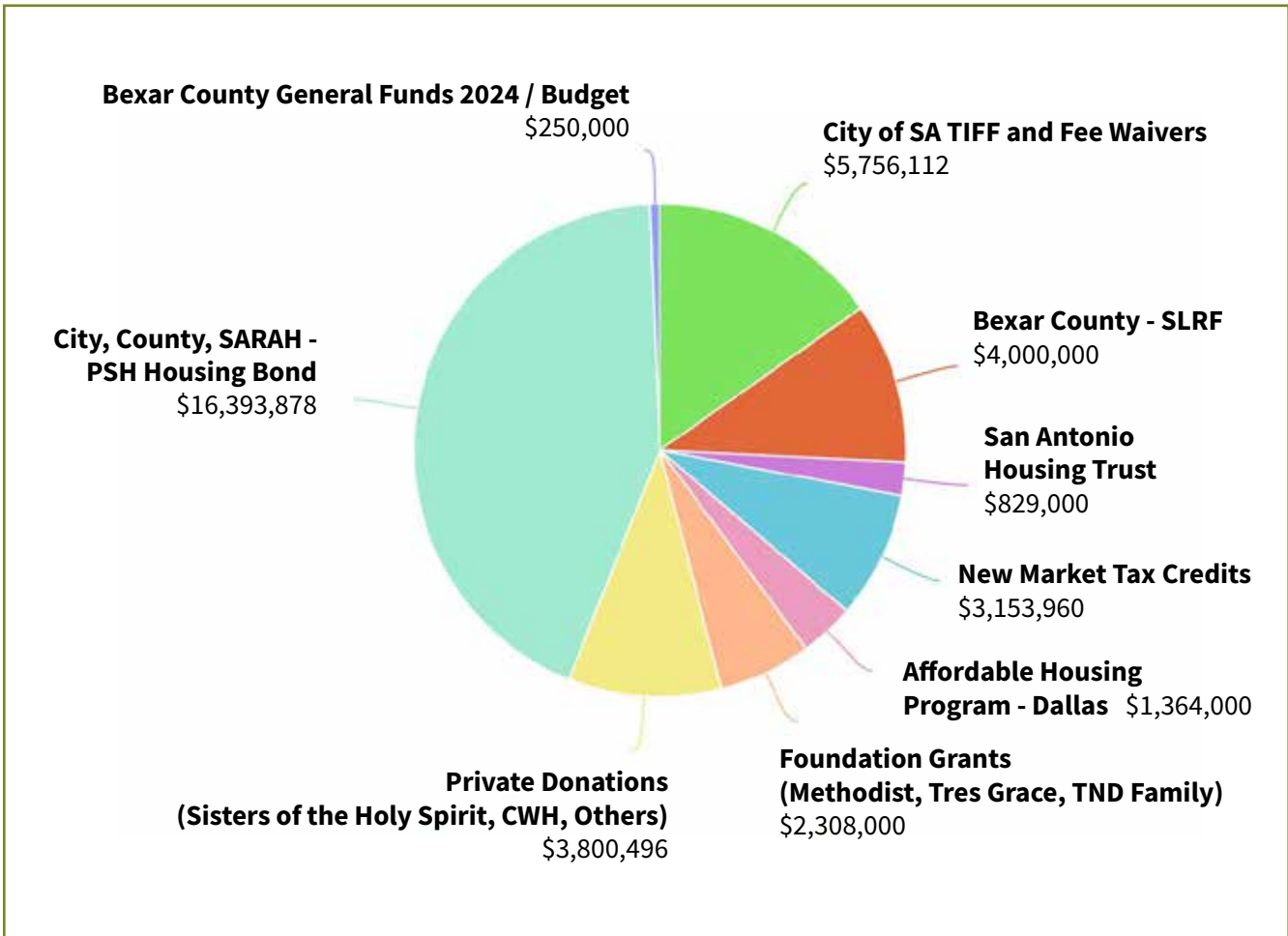



Towne Twin Village Helps San Antonio with Homelessness Goal

More than 3,372 of our neighbors in San Antonio experienced homelessness, according to the 2024 Point in Time Count. The national Point in Time Count, conducted by Close to Home, takes place every January to provide a snapshot view of the number of individuals experiencing homelessness, both sheltered and unsheltered. Of the total number of individuals experiencing homelessness, 17.7% are 55 and older.

Towne Twin Village is committed to reducing street homelessness by serving chronically unhoused, vulnerable individuals through Permanent Supportive Housing using evidence-based Housing First principles. We believe that all residents, volunteers and partners are vital to creating a supportive, collaborative environment that is welcoming and life-giving.

According to San Antonio’s Strategic Housing Implementation Plan (SHIP) of 2020, the goal is to add 1,000 units of net-based permanent supportive housing over the next 10 years. This effort is part of a broader strategy to reduce the percentage of unsheltered homelessness by 20%.



Towne Twin Village Site Masterplan

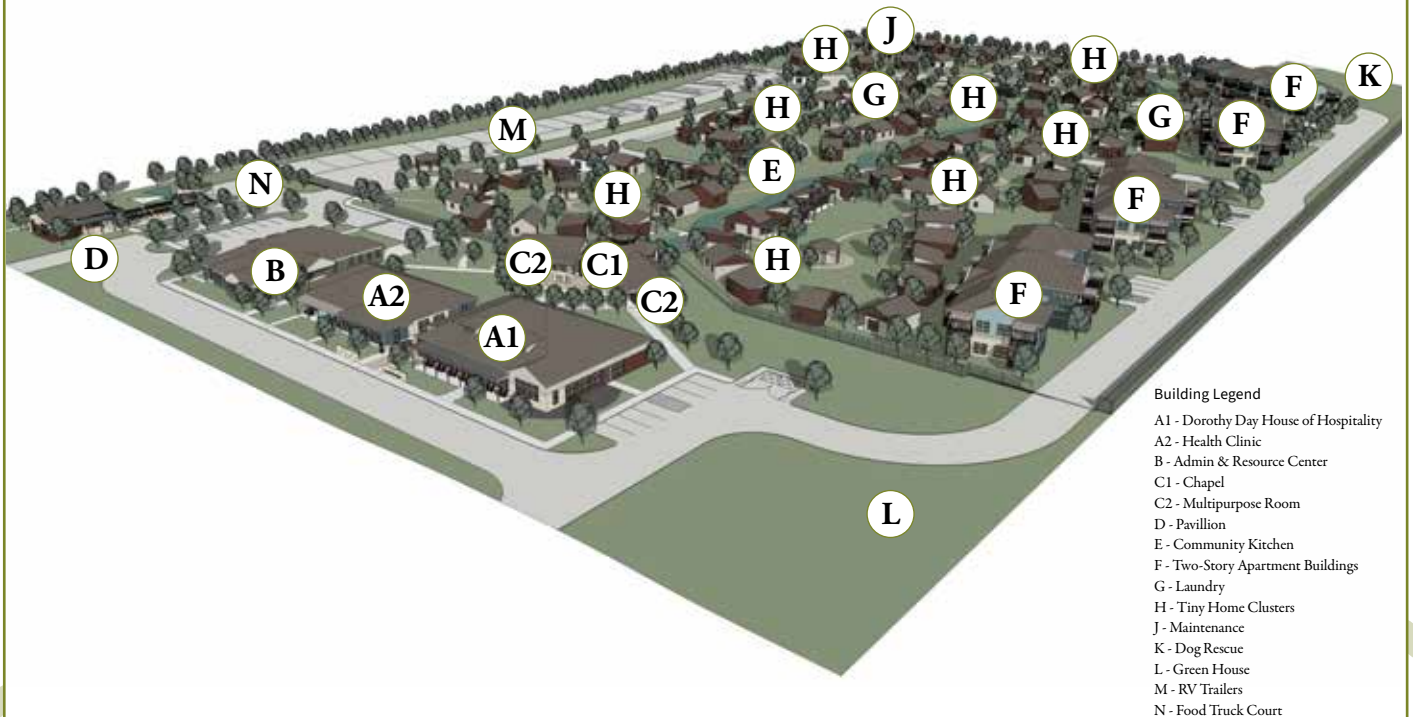



Average Years of Homelessness

The average number of years our residents lived on the streets is four, according to HUD policies, though this figure does not fully capture the extent of their experiences. Many of our residents have endured homelessness for longer, with some living on the streets for decades. One of our elders on campus, for instance, lived on the streets for 20 years before moving into his home at Towne Twin Village.

Our Demographics

Ethnicity / Race

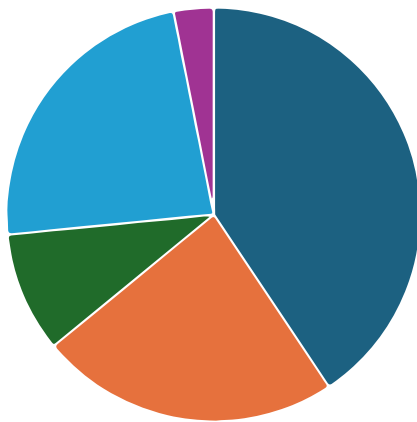

- Latino / Hispanic
- Black / African American
- American Indian
- White
- Native Hawaiian or Other Pacific Islander

Gender

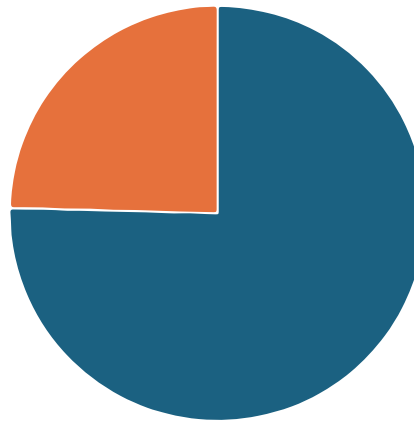

- Male
- Female

Income

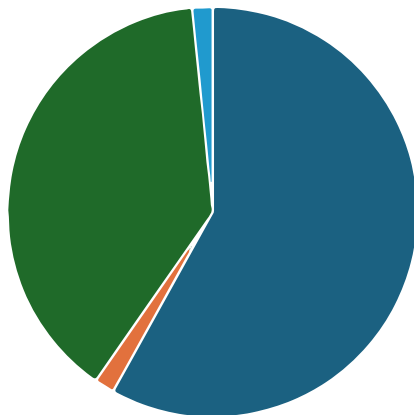

- \$0 - \$5,000
- \$5,001 - \$9,500
- \$9,501 - \$19,000
- \$43,501 - \$55,000

Income Source

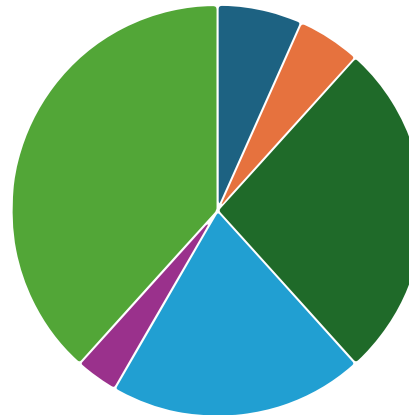

- Employment
- VA
- SSI
- SSDI
- Stipend
- No Income



What is Permanent Supportive Housing?

Permanent Supportive Housing is a compassionate and pragmatic approach to addressing one of the most pressing social issues of our time.

Permanent Supportive Housing is a crucial intervention in addressing chronic homelessness. By providing stable housing along with comprehensive support services, it offers a holistic approach to helping individuals rebuild their lives. This approach recognizes that homelessness is often not just a lack of shelter, but a complex combination of factors such as mental health issues, substance abuse, and lack of access to healthcare and employment opportunities.

The success of Permanent Supportive Housing lies in its ability to not only provide a roof over someone's head but also to address the underlying issues that may have contributed to their homelessness in the first place. Case management and supportive services play a pivotal role in helping individuals navigate these challenges, develop essential life skills, and connect with resources within the community.

Research has consistently shown the effectiveness of Permanent Supportive Housing in reducing chronic homelessness and improving overall well-being. By providing stability and support, it helps individuals break the cycle of homelessness and achieve long-term housing stability. Additionally, it has been demonstrated to be a cost-effective solution, as it reduces the reliance on expensive crisis services such as emergency shelters, hospitals, and the criminal justice system.



Judge Sakai statement on Towne Twin Village:

“An important step toward ending chronic homelessness is providing the most vulnerable in our population a safe, clean place to live. I am fully supportive of Towne Twin Village and consider this project to be a wonderful enhancement to Bexar County as a whole as we continue to work with stakeholders to address this basic need.”





Letter from Mayor Ron Nirenberg

City of San Antonio

Ron Nirenberg, Mayor

May 2024

In 2017 I created the Mayor's Housing Policy Task Force, and I charged them with creating a framework for a comprehensive, compassionate housing strategy for our city that culminated in a final report called the Housing Policy Framework. This report served as the foundation for the city's 10-year affordable housing plan titled the Strategic Housing Implementation Plan (SHIP) which identified the need for increased housing options with supportive services in our community.

As a city of compassion, San Antonio residents have continued to support the allocation of resources to initiatives that promote housing affordability in our city, including a voter approved \$150 million affordable housing bond in 2022. The needs of people experiencing homelessness are wide and diverse, and proven interventions, such as permanent supportive housing, require necessary investments to ensure that proper interventions are in place to help people exit homelessness permanently.

Despite the challenges stemming from a global pandemic, the Housing First Community Coalition remained steadfast in their commitment to create a truly remarkable project that is delivering on the promise of housing our neighbors who are most in need. As the first site-based permanent supportive housing community in San Antonio, Towne Twin Village represents a significant milestone in our mission to become a more welcoming city for all residents.

The spirit of Towne Twin is one that adheres to the principle of compassion, as the services that are provided here focus on making a person whole. This intentionality is not only reflected in the services provided on-site, but also in the physical infrastructure and layout of the homes.

I am committed to continue working on efforts that create opportunity for everyone, and Towne Twin Village is a shining example of a successful model in action. This effort, however, would not have been possible if not for the leadership of the Housing First Community Coalition, and the cadre of partners within the homeless response system working to collectively address the challenge of homelessness in our city. I am proud of the partnerships that have been forged in this community, and I am grateful that many residents now have an additional opportunity to live in safe, dignified housing in a community that respects and values their humanity.

Sincerely,

Ron Nirenberg
MAYOR





Mayors of South Texas Visit Towne Twin

The Mayor's Office brought a group of mayors from South Texas to tour Towne Twin Village during the convening of the South Texas Alliance of Cities to demonstrate the City of San Antonio's contribution and commitment to Permanent Supportive Housing. Mayor Ron Nirenberg states, "Increasing housing affordability and identifying solutions to homelessness are mutual goals shared by members of the South Texas Alliance of Cities. Towne Twin Village is a model South Texas community that demonstrates how homelessness can be solved through affordable housing partnerships."



After touring Towne Twin Village, the mayors of South Texas paused for a picture in front of the laundry building. Pictured with Edward Gonzales and Anna Downey are (in alphabetical order by city) Mayor John Cowen, Brownsville, Mayor Paulette Guajardo, Corpus Christi, Mayor Ramiro Garza, Edinburg, Mayor Norma Sepulveda, Harlingen, Mayor Dr. Victor Trevino, Laredo, Mayor Javier Villalobos, McAllen, Mayor Norie Gonzalez Garza, Mission, and San Antonio's own Mayor Ron Nirenberg.



"I like the peace and quiet of Towne Twin Village. The meals are awesome and the staff is so very helpful, patient, and kind."

- Neville



San Antonio Neighbors Together 2023 First Event Hosted on Towne Twin's Campus

Mark your calendars for October 1, 2024.

Towne Twin Village will be hosting the second annual Neighbors Together event on campus.



The residents, members of our larger neighborhood, staff and community leaders and liaisons celebrated our wonderful San Antonio community on October 3, 2023 for the first event on campus. Fun was had by all and a great sense of pride was evident with our residents as they participated in TTV's first festival-like event.

San Antonio Neighbors Together is an annual event held on the first Tuesday of October. The event focuses on strengthening relationships between local police and the communities they serve. At these events, neighborhoods connect with City departments to learn about resources available to keep our communities safe.



“The volunteers make Towne Twin Village a great place. Here I witness daily blessings, a true reminder that this is God’s work. To me it’s a new beginning.”

- **Ruben**



Towne Twin Village Donors

“The ache for home lives in all of us, the safe place where we can go as we are and not be questioned.” - Maya Angelou

Thank you to all of the donors who contributed to Towne Twin Village since its inception. The generosity of each donor has allowed HFCC to develop a beautiful, compassionate community for those formerly living on the streets.

The list below represents all of the gifts to HFCC over the last five years. In 2023, we started raising operational dollars to help transition from a solely capital campaign strategy, a strategy that was successful in actually creating, developing and implementing San Antonio’s first Permanent Supportive Housing Site with wrap-around services – Towne Twin Village.

If you would like to support our mission in 2024-2025, your gift, financial or otherwise – is always appreciated. For more information on how you can give, visit our website at <https://housingfirstsa.org/donate/>.





Construction

Dysart Consulting (Building Team and Executing Project)
Chesney Morales
Balanced Site Design
Wayne Rogers Construction
Jordan Foster Construction
Texas Homes

Champion

Bexar County
City of San Antonio
Dobson Family Foundations
Methodist Healthcare Ministries
San Antonio Housing Trust
Sisters of the Holy Spirit
Mik and Carol Stehling

Leader

Affordable Housing Program
John and Theresa Bruce
Cynthia Cano
Joan Cheever
DDM Foundation
Chris Plauche
Vance Family
WestCare Foundation
Mike Wilkes
Mark and Bebe Wittig
Nathan and Leticia Wittig

Builder

Ed Cross
Jennipher Dwyer
Jack and LaVerne Dysart
Frost Bank
Bonnie and Frank Gittinger
Jay Graber
Steve and Patricia Greefkens
Edwardo Guimbarda
Insite Architects
Katherine Kimm
Melanie Kirk
Marcia McKinley
Melovee White Trust
Nancy Moorman
Susan O'Brien
Breck Plauche
George and Mary Ellen Powers
Lynn Powers
David Reed
Veronica Salazar
Mike Schroeder
Shield-Ayres Foundation
St. John's Baptist Church
St. Mark's Episcopal Church
Cliff Waller
Wells-Fargo Foundation
Sharon Wetherington
Joe and Linda Wittig

Supporter

Susan Brotherman
Corey Cunningham
Molly Cuny
Daffy Charitable Fund
Catherine Galle
Laurel Galli-Graves
Mike and Angela Carrett
Karl Graf
Mary Hibberd
Kathryn Howe
Bill Lyons
Steve and Jill Markey
Sharon and Samuel Mungo
Allen and Susan Nickel
Greg Pape
Hector Pena
Saint Andrew Presbyterian Church
San Antonio Area Foundation
Charles and Kathy Schmidt
Center for Healthcare Services
Darcy Beach
Evan Wittig

Friend

Scott Ackerson
Jane Acri
Barbara Alvarez
Tammy Alvarez
Emily Baker
Rebecca Baker
Dixie Bane
Benevity Community Impact
Kristin Bengoechea
Cathy Bennett
Conrad Boeck
Allyson Bowles
Carly Bozka
Peter Braueler
Michael Brough
Virginia Burns
Madeline Carrola
Courtney Cash
Natonya Cash
Rebecca Brennan Chiappone
Elizabeth Chiego
Susan Christensen
Angeline Cione
Roland Conwell
Margaret and Ed Cuny
John and Velma Danielson
Eric Darmstetter
Kristin Davila
James Dawes
Holly Dean
Celeste Derozier
Dignity San Antonio
Brian Dillard
Lynn Dobb
David Dodge
Anna Downey
Kevin Downey

Friend

Kerri Echols
John B. Elder
Rene Escabedo
Steve and Shelley Fillipp
First Capital Group Management
Donna Fisher
Roger Flores
Elizabeth Franklin
Friends Meeting of San Antonio
Arthur Garcia
Gerald and Kerry Tripp Trust
Dan and Jean Goetz
Calissa Gonzales
Edward Gonzales
Alyssa Gooch
Ruth Graeter
Crystal Grafft
Karen Green
Allison Greer Friends
Robert Guevara
Beth Harrison
Daniel Hatoum
Gretchen Haynes
Katherine and Paul Hess
Robert and Mary Hintermaier
Bob and Colleen Irland
Susan Ives
Dawn and Mark Johnson
Ezra Johnson
Mark Johnson
Sharon Kemp
Kevin Tuerff Consulting
Aquilah King
Stephanie Koithan
Susan Korschak-Ives
Craig Krueger
Gerald Krueger
Nick Krueger
Helen Langham
Mike and Mary Kay Leatherman
Dr. John Lewis
Susan Lisk
David Lodge
Tannie Lowe
Joseph Luedecke
George Luhn
Rhomus and Charlotte Magott
William Mahone III
John Markey
Patrick Markey
Richard Martinez
Vanessa Martinez
Sheila Maxey
Barbara McCarthy
Cionne McCarthy
Patrick Shane McCarthy
Kathleen McChesney
James "Ritchie" McCullouch

Friend

Daniel McGuire
Meredith McGuire
Sean McMains
Deborah McNabb
Amanda Meigs
Tia Moen
Walker and Tasha Moore
Ray Morales
Patrick Muehlberger
Bill Neely
Katherine Paredes
Shell Patel
George Patrin
Nayeli Perez
Claudia Pharr
Kristine Pharr
Donald and Elise Plauche
David and Beth Pocta
Sandra Ponce-Fuentes
Malea Potter
Chris and Jessica Powers
Amy Protos
Heather Pullen
Melissa Radzysinski
SHM Reynolds
Alice Salinas
Dee Sanchez
James Schellenberg
Pat Schieffer
Jonathon Schneider
Select Federal Credit Union
Hedy Senz
Rebecca Sheddick
Terah Sherwood
James Spickard
St. Luke's Episcopal Church
Mollie and Billy Stinson
Michael Storbeck
Dianne Talbert
Paula and Lindsay Taliaferro
Blackbaud Giving Fund
Vicky Towers
Tina Travieso
James Tuerff
Barbara Turk
Arthur Uhl
Katie Vela
Fernando Velazquez
Sandra Vetter
Nathan Von Griffin
Charlotte Walker
Zachary Walsh
Wendy Wayt
Monica West
Barbara Whitney
Ione Willeford
Luke Wittig
Michael and Linda Wonderly
Jim and Arlene Wueste



TOWNE TWIN
— VILLAGE —

